



# KRUUSE S.Q.R.U.B. SPECULUM CLEANER

## Safe & Quick Removal of Unwanted Bacteria

The S.Q.R.U.B. speculum cleaner is a most useful cleaning device. It improves and simplifies the cleaning procedure and provides the patient with high care. The S.Q.R.U.B. cleans 3 mm to 5 mm otoscope speculum instantly.

Before use on another patient the speculum ought to be clean to prevent transmission of infection. A study performed at a University hospital concluded proper mechanical washing (using a brush) is superior to hand washing in eliminating bacterial contaminants.

The S.Q.R.U.B. is compatible with all known microbial disinfectants, just make sure it is 3/4 full when in use.

### To Clean a Speculum:

1. Insert the speculum into the top of the S.Q.R.U.B., small end first.
2. Move the speculum up and down several times.
3. Remove the speculum.

**Note:** Additional measures are required to sterilize.

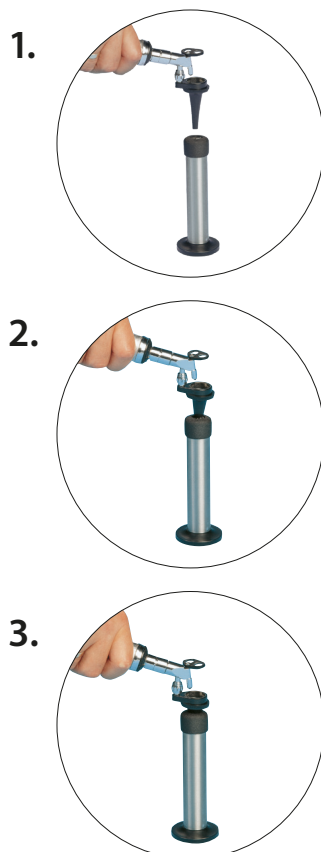

### To Clean the S.Q.R.U.B.

1. Empty the S.Q.R.U.B.
2. Remove the top cap (1) and the base (2).
3. Remove the brush cartridge (4).
4. Remove the middle brush from the cartridge and use it to clean the other components.
5. Assemble the S.Q.R.U.B. reversing steps 1-4

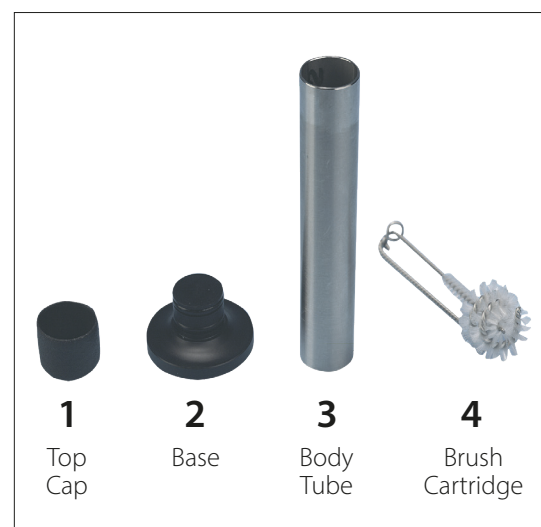

It is important to keep your S.Q.R.U.B. in good condition. With a little care and cleaning, the S.Q.R.U.B. will provide many years of service. All metal parts are made of stainless steel and the brushes, which are made of high grade nylon, are very long lasting. You can improve its performance by regular maintenance.

270112

kruise.com